

Sustainable Urban Drainage

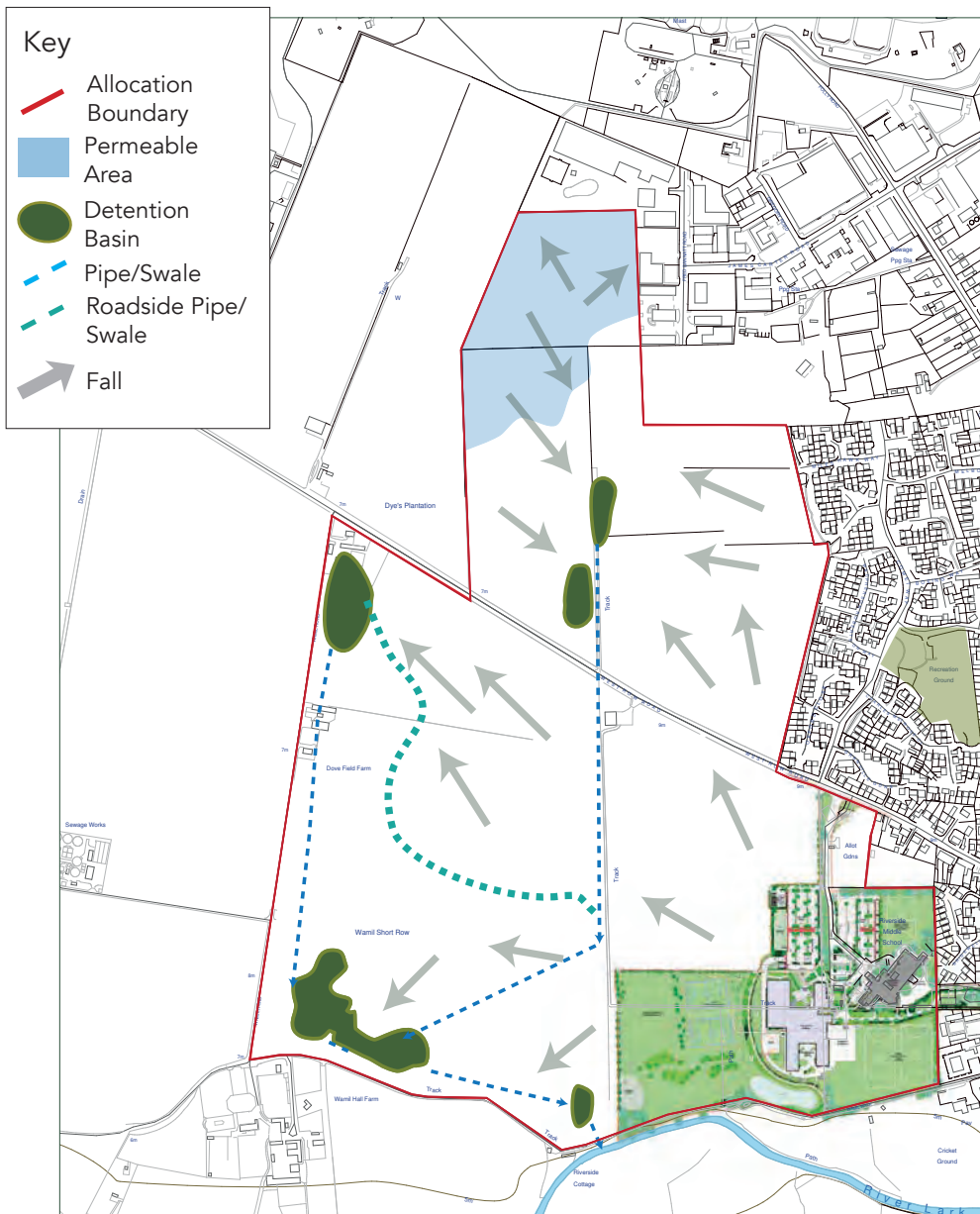

Example of a part wet detention basin



Example of a dry detention basin



Example of a road side swale



Example of a green route swale

Drainage Strategy (Blue Infrastructure)

This board illustrates a conceptual drainage strategy for the site utilising Sustainable Urban Drainage Systems taking into account the site levels and features within a framework and your feedback will inform the evolution of the Masterplan. The drainage strategy is designed to ensure that surface water flowing from the site is directed into the RiverLark and the rate of flow is managed, taking into account an allowance for future climate change and ensuring wherever possible a betterment on the current situation. This accords with best practice Sustainable Urban Drainage Systems.

To achieve this, a number of drainage measures are proposed to manage and control water flows across the site and their discharge into River Lark. These measures include on plot attenuation for the commercial land uses in the north of the site, swales (specifically designed drainage ditches) and attenuation basins (dry basins) that hold water within the site at times of heavy rainfall, with a 48HR drain rate (but are otherwise dry and useable) and enable water to be released at a steady rate. The strategy accords with the Sustainable Urban Drainage Systems (SUDS) Design Guide and will also include additional capacity for climate change.

Please provide us with your feedback concerning this information here [REDACTED]

Please read this exhibition material in conjunction with the virtual exhibition at www.westofmildenhall.co.uk